

SORIO-U

Direct | Pendant



SORIO-U Luminaire with Extruded aluminium housing and with premium powder coating finish.

Powered by high quality LED's with a binning tolerance of ≤ 3 SDCM and CRI ≥ 90 . The luminaire maintains atleast 70% of its luminous flux after 50,000 operating hours, guaranteeing long term reliability. High efficiency Lens provides glare control and uniform illumination.

With a standard size of 1200mm length, this fixture is crafted for direct light distribution, making it ideal for professional applications.

Customisations in RAL finish, Wattages and Length available as per request to enhance installation and functionality.

Single Line Diagram

Pendant Mounted

Profile Code
SDL-3006

Profile Code
SDL-3005

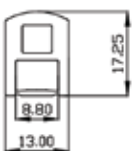

SORIO-U



Quick Info

Mounting Type

Pendant

Material Colour

Customize RAL available

Protection mode

IP40

Driver Details

ON/OFF/, DALI-2 DT6 / DALI-2 DT8/ DALI +

Power Factor (PF) -0.95

THD- <10%

UGR - <19

LED

CCT- 3000K/ 4000K/ 5700K/ TUNABLE WHITE 2700K-6500K

CRI- ≥ 90

Life Span - L70@50000h

MacAdam - ≤ 3 SDCM

Beam Angle

35°

Optics

Lens

Efficacy

3000K- 97.3

4000K- 116.21

5700K- 128.93

Tunable White 2700K-6500K- 116.21

Electrical

Wattage - 20W/4ft

Opt Wattages Available -5W/4ft, 10W/4ft, 15W/4ft

Input Voltage- 220-240 VAC

Physical Dimensions

Length- 1200mm